

serie
UCF300

DPI[®]
BEARINGS

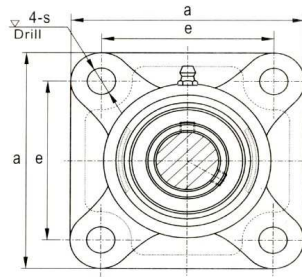
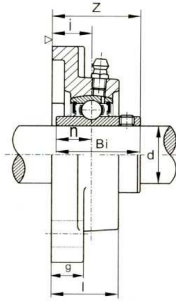

Bearing unit No.	Shaft	Dimension /mm/									Bolt used /mm/	Bearing No.:	Housing No.:	Weight /kg/
	d /mm/	a	e	i	g	l	S	Z	Bi	n				
UCF 305	25	110,0	80	16	13	29	16	39	38	15,0	M14	UC 305	F 305	1,20
UCF 306	30	125,0	95	18	15	32	16	44	43	17,0	M14	UC 306	F 306	1,80
UCF 307	35	135,0	100	20	16	36	19	49	48	19,0	M16	UC 307	F307	2,20
UCF 308	40	150,0	112	23	17	40	19	56	52	19,0	M16	UC 308	F308	3,00
UCF 309	45	160,0	125	25	18	44	19	60	57	22,0	M16	UC 309	F 309	3,80
UCF 310	50	175,0	132	28	19	48	23	67	61	22,0	M20	UC 310	F 310	4,90
UCF 311	55	185,0	140	30	20	52	23	71	66	25,0	M20	UC 311	F 311	5,60
UCF 312	60	195,0	150	33	22	56	23	78	71	26,0	M20	UC 312	F 312	6,80
UCF 313	65	208,0	166	33	22	58	23	78	75	30,0	M20	UC 313	F 313	7,80
UCF 314	70	226,0	178	36	25	61	25	81	78	33,0	M22	UC 314	F 314	9,80
UCF 315	75	236,0	184	39	25	66	25	89	82	32,0	M22	UC 315	F 315	11,60
UCF 316	80	250,0	196	39	27	68	31	90	86	34,0	M27	UC 316	F 316	13,20
UCF 317	85	260,0	204	44	27	74	31	100	96	40,0	M27	UC 317	F 317	15,20
UCF 318	90	280,0	216	44	30	76	35	100	96	40,0	M30	UC 318	F 318	18,80
UCF 319	95	290,0	228	59	30	94	35	121	103	41,0	M30	UC 319	F 319	21,10
UCF 320	100	310,0	242	59	32	94	38	125	108	42,0	M33	UC 320	F 320	25,30
UCF 322	110	340,0	266	60	35	96	41	131	117	46,0	M36	UC 322	F 322	35,00
UCF 324	120	370,0	290	65	40	110	41	140	126	51,0	M36	UC 324	F 324	47,20
UCF 326	130	410,0	320	65	45	115	41	146	135	54,0	M36	UC 326	F 326	64,10
UCF 328	140	450,0	350	75	55	125	41	161	145	59,0	M36	UC 328	F 328	90,20