

serie
UCFL300

DPI
BEARINGS

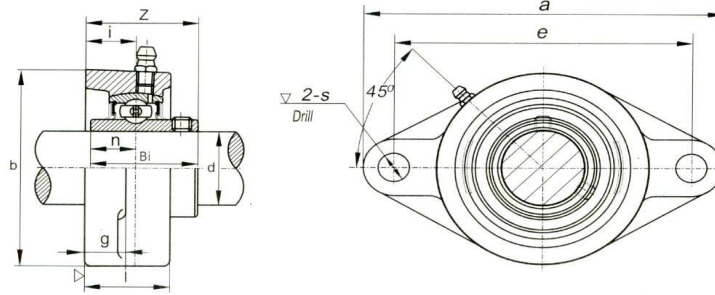

| Bearing unit No. | Shaft | Dimension /mm/ | | | | | | | | | | Bolt used /mm/ | Bearing No.: | Housing No.: | Weight /kg/ |
|------------------|--------|----------------|-----|----|----|-----|----|-----|-----|-----|------|----------------|--------------|--------------|-------------|
| | d /mm/ | a | e | i | g | l | S | b | Z | Bi | n | | | | |
| UCFL 305 | 25 | 150 | 113 | 16 | 13 | 29 | 19 | 80 | 39 | 38 | 15,0 | M16 | UC 305 | FL 305 | 1,1 |
| UCFL 306 | 30 | 180 | 134 | 18 | 15 | 32 | 23 | 90 | 44 | 43 | 17,0 | M20 | UC 306 | FL 306 | 1,5 |
| UCFL 307 | 35 | 185 | 141 | 20 | 16 | 36 | 23 | 100 | 49 | 48 | 19,0 | M20 | UC 307 | FL 307 | 1,8 |
| UCFL 308 | 40 | 200 | 158 | 23 | 17 | 40 | 23 | 112 | 56 | 52 | 19,0 | M20 | UC 308 | FL 308 | 2,4 |
| UCFL 309 | 45 | 230 | 177 | 25 | 18 | 44 | 25 | 125 | 60 | 57 | 22,0 | M22 | UC 309 | FL 309 | 3,4 |
| UCFL 310 | 50 | 240 | 187 | 28 | 19 | 48 | 25 | 140 | 67 | 61 | 22,0 | M22 | UC 310 | FL 310 | 4,3 |
| UCFL 311 | 55 | 250 | 198 | 30 | 20 | 52 | 25 | 150 | 71 | 66 | 25,0 | M22 | UC 311 | FL 311 | 5,2 |
| UCFL 312 | 60 | 270 | 212 | 33 | 22 | 56 | 31 | 160 | 78 | 71 | 26,0 | M27 | UC 312 | FL 312 | 6,3 |
| UCFL 313 | 65 | 295 | 240 | 33 | 25 | 58 | 31 | 175 | 78 | 75 | 30,0 | M27 | UC 313 | FL 313 | 7,9 |
| UCFL 314 | 70 | 315 | 250 | 36 | 28 | 61 | 35 | 185 | 81 | 78 | 33,0 | M30 | UC 314 | FL 314 | 9,3 |
| UCFL 315 | 75 | 320 | 260 | 39 | 30 | 66 | 35 | 195 | 89 | 82 | 32,0 | M30 | UC 315 | FL 315 | 10,6 |
| UCFL 316 | 80 | 355 | 285 | 38 | 32 | 68 | 38 | 210 | 90 | 86 | 34,0 | M33 | UC 316 | FL 316 | 13,5 |
| UCFL 317 | 85 | 370 | 300 | 44 | 32 | 74 | 38 | 220 | 100 | 96 | 40,0 | M33 | UC 317 | FL 317 | 15,2 |
| UCFL 318 | 90 | 385 | 315 | 44 | 36 | 76 | 38 | 235 | 100 | 96 | 40,0 | M33 | UC 318 | FL 318 | 18,0 |
| UCFL 319 | 95 | 405 | 330 | 59 | 40 | 94 | 41 | 250 | 121 | 103 | 41,0 | M36 | UC 319 | FL 319 | 22,7 |
| UCFL 320 | 100 | 440 | 360 | 59 | 40 | 94 | 44 | 270 | 125 | 108 | 42,0 | M39 | UC 320 | FL 320 | 27,2 |
| UCFL 322 | 110 | 470 | 390 | 60 | 42 | 96 | 44 | 300 | 131 | 117 | 46,0 | M39 | UC 322 | FL 322 | 34,2 |
| UCFL 324 | 120 | 520 | 430 | 65 | 48 | 110 | 47 | 330 | 140 | 126 | 51,0 | M42 | UC 324 | FL 324 | 48,1 |
| UCFL 326 | 130 | 550 | 460 | 65 | 50 | 115 | 47 | 360 | 146 | 135 | 54,0 | M42 | UC 326 | FL 326 | 59,5 |
| UCFL 328 | 140 | 600 | 500 | 75 | 60 | 125 | 51 | 400 | 161 | 145 | 59,0 | M45 | UC 328 | FL 328 | 73,5 |